

Avanti®

INSTRUCTION MANUAL MANUAL DE INSTRUCCIONES

Model Numbers: 499SYWL/499SYBL

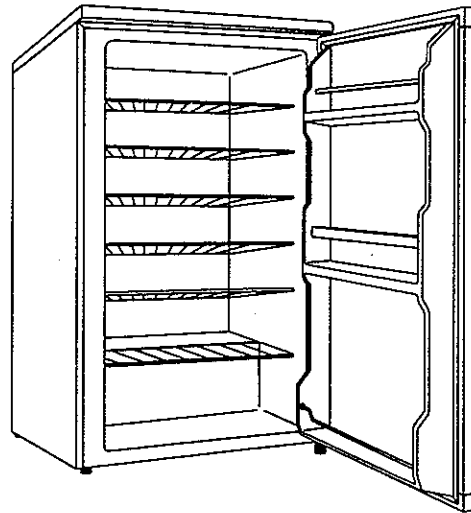

CAUTION:

BEFORE USE, PLEASE READ AND FOLLOW ALL SAFETY RULES AND OPERATING INSTRUCTIONS.

Avanti has a policy of continuous improvement on its products and reserves the right to change materials and specifications without notice.

Avanti Products, A Division of The Mackle Co., Inc.

P.O. Box 520604-Miami, Florida 33152

www.avantiproducs.com

Warranty Information

Thank you for purchasing this fine Avanti product. Please fill out this card and return it within 100 days of purchase and receive these important benefits:

- **Confirm your warranty:**
Your prompt product registration confirms your right to the protection available under the terms and conditions of your Avanti warranty.
- **Protect your product:**
We will keep the model number and date of purchase of your new Avanti product on file to help you refer to this information in the event of an insurance claim such as fire or theft.
- **Promote better products:**
We value your input. Your response will help us develop products designed to best meet your future needs.

----- (detach here) -----

Avanti Registration Card

Name

Model #

Serial #

Address

Date Purchased

Store/Dealer Name

City

State

Zip

Occupation

Area Code Phone Number

As Your Primary Residence, Do You:

Did You Purchase An Additional

Own Rent

Warranty:

Extended Food Loss None

Your Age:

under 18 18-25 26-30
 31-35 36-50 over 50

Reason For Choosing This Avanti

Marital Status:

Product:

Married Single

Please indicate the most important factors that influenced your decision to purchase this product.

Is This Product Used In The:

Price

Home Business

Product Features

How Did You Learn About This

Avanti Reputation

Product:

Product Quality

Advertising Product Features

Salesperson Recommendation

In Store Demo Personal Demo

Friend/Relative Recommendation

Other _____

Warranty

Comments _____

Other _____

HELP US HELP YOU...

Read this guide carefully.

This guide is intended to help you operate and maintain your new refrigerator properly.

Keep it handy to answer your questions. If you don't understand something or you need more help, please call:

Avanti Customer Service
800-220-5570

Keep proof of original purchase date (such as your sales slip) with this guide to establish the warranty period.

CAUTION:

**THIS APPLIANCE IS
NOT DESIGNED FOR
THE STORAGE OF
MEDICINE OR OTHER
MEDICAL PRODUCTS.**

Write down the model and serial numbers.

You'll find them on a plate located on back wall of the appliance.

Please write these numbers here:

Date of Purchase

Model Number

Serial Number

Use these numbers in any correspondence or service calls concerning your appliance.

If you received a damaged appliance, immediately contact the dealer (or builder) that sold you the appliance.

Save time and money. Before you call for service, check the Troubleshooting Guide. It lists causes of minor operating problems that you can correct yourself.

IF YOU NEED SERVICE

We're proud of our service and want you to be pleased. If for some reason you are not happy with the service you receive, here are some steps to follow for further help.

FIRST, contact the people who serviced your appliance. Explain why you are not pleased. In most cases, this will solve the problem.

NEXT, if you are still not pleased, write all the details, including your telephone number, and send to:

Customer Service
Avanti Products
10880 NW 30 Street
Miami, FL 33172

PARTS AND FEATURES

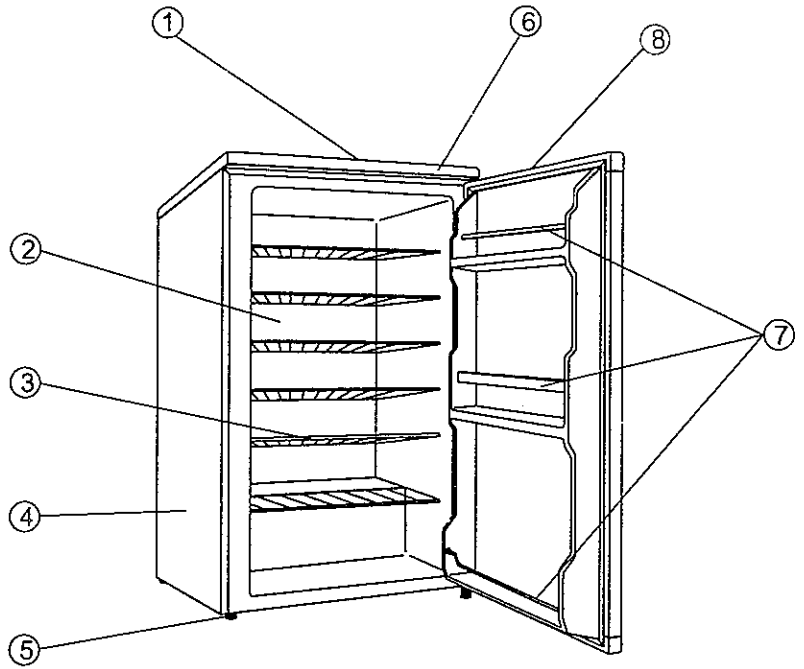

① Temperature Control

② Drain Hole

③ Removable Shelves

④ Drip Tray

⑤ Leveling Leg

⑥ Counter Top

⑦ Bottle Racks

⑧ Lock

Table of Contents

Warranty Information and Registration Card	1
Help Us Help You	2
Parts and Features	3
Important Safety Instructions	5
Installation Instructions	5
Before Using Your appliance	5
Installation of Your appliance	6
Electrical Connection	6
Reversing the Door Swing of Your appliance	7
Operating Your appliance	8
Temperature Control	8
Care and Maintenance	8
Cleaning Your Appliance	8
Vacation Time	8
Moving Your appliance	8
Water Collection Tray	8
Energy Saving Tips	8
Troubleshooting Guide	9
Service For Your Appliance	10
Your Avanti Products Warranty	11
Parts Breakdown	12
Parts List	13
Wiring Diagrams	14
Spanish Section	15,16,17,18

Important Safety Instructions

 WARNING ✎	To reduce the risk of fire, electric shock, or injury when using your appliance, follow these basic precautions:
<ul style="list-style-type: none">• Read all instructions before using the appliance.• DANGER or WARNING: Risk of child entrapment.• Child entrapment and suffocation are not problems of the past. Junked or abandoned appliances are still dangerous... even if they will "just sit in the garage a few days."• Before you throw away your old refrigerator or freezer: Take off the doors. Leave the shelves in place so that children may not easily climb inside.• Never allow children to operate, play with, or crawl inside the appliance.• Never clean appliance parts with flammable fluids. The fumes can create a fire hazard or explosion.• Do not store or use gasoline or any other flammable vapors and liquids in the vicinity of this or any other appliance. The fumes can create a fire hazard or explosion. <p style="text-align: center;">-Save these instructions-</p>	

Installation Instructions

➤ Before Using Your appliance

- Remove the exterior and interior packing.
- Check to be sure you have all of the following parts:
 - 4 Shelves
 - 2 Wine Racks
 - Instruction Manual
- Before connecting the appliance to the power source, let it stand upright for approximately two hours. This will reduce the possibility of a malfunction in the cooling system from handling during transportation.
- Cleaning the interior surface with lukewarm water using a soft cloth.

Note: Your unit contains extra shelves for a variety of choices. You can use your all refrigerator to store white wine as well as sodas. All of the shelves will not work effectively in the unit at same time.

Installation of Your appliance

- Place your appliance on a floor that is strong enough to support the appliance when it is fully loaded. To level your appliance, adjust the legs at the front of the appliance.
- Allow 5 inches of space between the back and sides of the appliance, which allows the proper air circulation to cool the compressor.
- Locate the appliance away from direct sunlight and sources of heat (stove, heater, radiator, etc.). Direct sunlight may affect the acrylic coating and heat sources may increase electrical consumption. Extreme cold ambient temperatures may also cause the appliance not to perform properly.
- Avoid locating the appliance in moist areas. Too much moisture in the air will cause frost to form quickly on the evaporator requiring more frequent defrosting of the appliance.
- Plug the appliance into an exclusive properly installed-grounded wall outlet. Do not under any circumstances cut or remove the third (ground) prong from the power cord. Any questions concerning power and or grounding should be directed toward a certified electrician or an authorized Avanti Products service center.

➤ Electrical Connection

⚡ Warning ⚡

Improper use of the grounded plug can result in the risk of electrical shock. If the power cord is damaged, have it replaced by an authorized Avanti products service center.

This appliance should be properly grounded for your safety. The power cord of this appliance is equipped with a three-prong plug which mates with standard three prong wall outlets to minimize the possibility of electrical shock.

Do not under any circumstances cut or remove the third grounded prong from the power cord supplied.

Use of extension cords is not recommended.

This appliance requires a standard 115/120 volt, 60Hz electrical outlet with three-prong ground. The cord should be secured behind the appliance and not left exposed or dangling to prevent accidental injury.

➤ Reversing the Door Swing of Your Appliance

This appliance has the capability of either opening the door from the left or right side. This unit is delivered to you with the door opening from the left side. Should you desire to reverse the opening direction, please follow these instructions.

NOTE:

All parts removed must be saved to do the reinstallation of the door.

- Remove the two screws (1) that hold the lower hinge (2) (right side) to the frame. Also, remove the screw-type leveling front leg(3).
- Remove the left front leg (4) and transfer it to the right side.
- Lift the door and place it on a padded surface to prevent scratching it. Make sure to remove the spring (5) located inside the upper right hole of the door and the upper right side pin (6).
- Remove the plug button (7) from the upper left hole of the door and transfer it to the uncovered hole at the right side. Be sure to press the button firmly into the hole.
- Insert the upper pin (6) previously removed from the right side (step 3) and transfer it to the other hole at the left side of the top frame.
- Insert the spring (5) previously removed (step 3) inside the upper left side hole of the door.
- Set the door in place making sure the pin (6) enters the bushing at the lower upper frame section (hole).
- While holding the door in the closed position, secure the lower left hinge (2) previously removed (step 1). Before placing this lower hinge, remove the upper bolt-pin (8) and reverse the direction of the hinge.
- Insert the bolt-pin (8) and do not tighten until the top of the door is leveled with the counter top.
- Insert the two screws (1) previously removed (step 1) and tighten them.

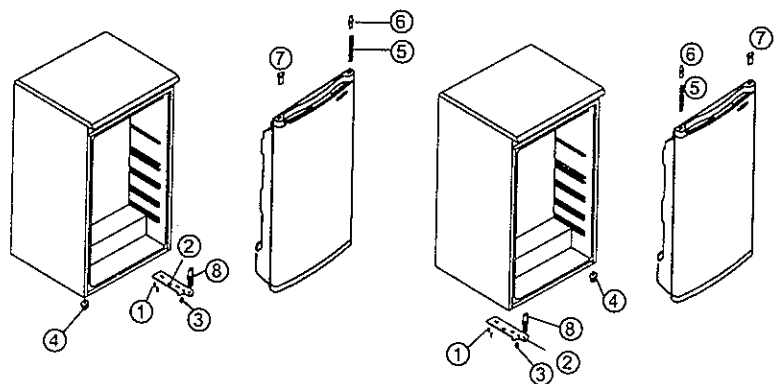

FIGURE 1(Position prior to door reversal)

FIGURE 2(Position after door reversal)

- ① -Door Hinge Screws
- ② -Lower Door Hinge
- ③ -Front Leveling Legs
- ④ -Left Front Leg

- ⑤ -Door Frame Spring
- ⑥ -Door Frame Pin
- ⑦ -Hinge Plug(Door Frame)Left Side
- ⑧ -Door Hinge Bolt

OPERATING YOUR APPLIANCE

➤ Temperature Control

- The temperature control dial has settings from the warmest "MIN" to the coldest "MAX", plus "OFF".
- The first time you turn the unit on set the temperature control to the "MAX" or the mid-position
- Turning the control to the "OFF" position stops the cooling cycle, but does not shut off the power to the appliance.
- If the unit is unplugged, power lost, or turned off; you must wait 3 to 5 minutes before restarting the unit. If you attempt to restart before this time delay, the appliance will not start.

CARE AND MAINTENANCE

➤ Cleaning Your Appliance

- Turn the temperature control to "OFF", unplug the appliance, and remove the contents.
- Wash the inside with a warm water and baking soda solution. The solution should be about 2 tablespoons of baking soda to a quart of water.
- Wash the shelves with a mild detergent solution.
- The outside of the appliance should be cleaned with mild detergent and warm water.

➤ Vacation Time

During long absences, remove all contents; unplug your appliance, clean your appliance, and leave the door open slightly to avoid possible formation of condensation, mold, or odors.

➤ Moving Your Appliance

- Remove all the contents.
- Securely tape down all loose items inside your appliance.
- Turn the leveling screws up to the base to avoid damage.
- Tape the doors shut.
- Be sure the appliance stays in the upright position during transportation.

➤ Water Collection Tray

- When the compressor is not operating, water drops collect and drain through the outlet in the inner back wall into the drain pan located above the compressor.
- To clean tray if necessary, remove the 2 screws holding it against the back wall.
- Pull the tray forward and replace it once cleaned.

➤ Energy Saving Tips

- The appliance should be located in the coolest area of the room, away from heat producing appliances or heating ducts, and out of the direct sunlight.
- Overloading the appliance forces the compressor to run longer.

PROBLEMS WITH YOUR APPLIANCE?

You can solve many common appliance problems easily, saving you the cost of a possible service call. Try the suggestions below to see if you can solve the problem before calling the servicer.

TROUBLESHOOTING GUIDE

PROBLEM	POSSIBLE CAUSE
Appliance does not operate.	Not plugged in. The circuit breaker tripped or blown fuse. The appliance temperature control is set at "OFF".
Compressor turns on and off frequently.	The room temperature is hotter than normal. A large amount of items have been added to the appliance. The door is opened too often. The door is not closed completely. The temperature control is not set correctly. The door gasket does not seal properly. The appliance does not have the correct clearances.
Vibrations.	Check to assure that the appliance is level.
The appliance seems to make too much noise.	The rattling noise may come from the flow of the refrigerant, which is normal. As each cycle ends, you may hear gurgling sounds caused by the flow of refrigerant in your appliance. Contraction and expansion of the inside walls may cause popping and crackling noises. The appliance is not level.
The door will not close properly.	The appliance is not level. The door is reversed and not properly installed. The gasket is dirty. The shelves are out of position.

SERVICE FOR YOUR APPLIANCE

We are proud of our customer service organization and the network of professional service technicians that provide service on your Avanti appliances. With the purchase of your Avanti appliance, you can have the confidence that if you ever need additional information or assistance, the Avanti Products Customer Service team will be here for you. Just call us toll-free.

AVANTI PRODUCTS CUSTOMER SERVICES

Product Information 800-323-5029	Whatever your questions are about our products, help is available.
Part Orders 800-220-5570	You may order parts and accessories that will be delivered directly to your home. You may order these items by personal check, money order, Master Card, or Visa.
In-Home Repair Service 800-220-5570	An Avanti Products authorized service center will provide expert repair service, scheduled at a time that is convenient for you. Our trained servicers know your appliance inside and out.

**YOUR Avanti Products
WARRANTY**

Staple your sales receipt here.
Proof of original purchase date
is needed to obtain service
under warranty.

**WHAT IS COVERED LIMITED
ONE-YEAR WARRANTY**

For one year from the date of purchase by the original owner, Avanti Products will, at its option, repair or replace any part of the appliance which proves to be defective in material or workmanship under normal use. During this period Avanti Products will provide all parts and labor necessary to correct such defects free of charge, so long as the appliance has been installed and operated in accordance with the written instructions in this manual. In rental or commercial use, the warranty period is 90 days. All Avanti Appliances of 3.5 cubic feet capacity or less must be brought/sent to the appliance service shop for repair.

**LIMITED SECOND THROUGH
FIFTH YEAR WARRANTY**

For the second through the fifth year from date of original purchase, Avanti Products will provide a replacement compressor free of charge due to a failure. You are responsible for the service labor and freight charges. In rental or commercial use, the limited compressor warranty is one year and nine months. Cost to move the appliance to the servicers' shop and back to the user's home, as may be required, are the user's responsibility.

WHAT IS NOT COVERED

- Content losses of food due to spoilage.
- Incidental or consequential damages.
- Parts and labor costs for the following will not be considered as warranty.
- Evaporator doors, door spring, and/or frames.
- Inner door panels, door shelves, door rails, and/or door supports.
- Chest appliance lid liners.
- Vegetable crispers..
- Light bulbs and/or plastic housing.
- Plastic cabinet liners.
- Punctured evaporator that voids the warranty on the complete sealed system.
- Repairs performed by unauthorized services.
- Service calls that do not involve defects in material or workmanship such as customer education, door reversal, or proper installation.
- Service calls that are related to external problems, such as abuse, misuse, inadequate electrical power, accidents, fire, floods, or acts of God.
- Replacement of house fuses or resetting circuit breakers.
- Failure of the product if it is used for other than its intended purpose.
- This warranty does not apply outside the continental U.S.A..

PARTS BREAKDOWN

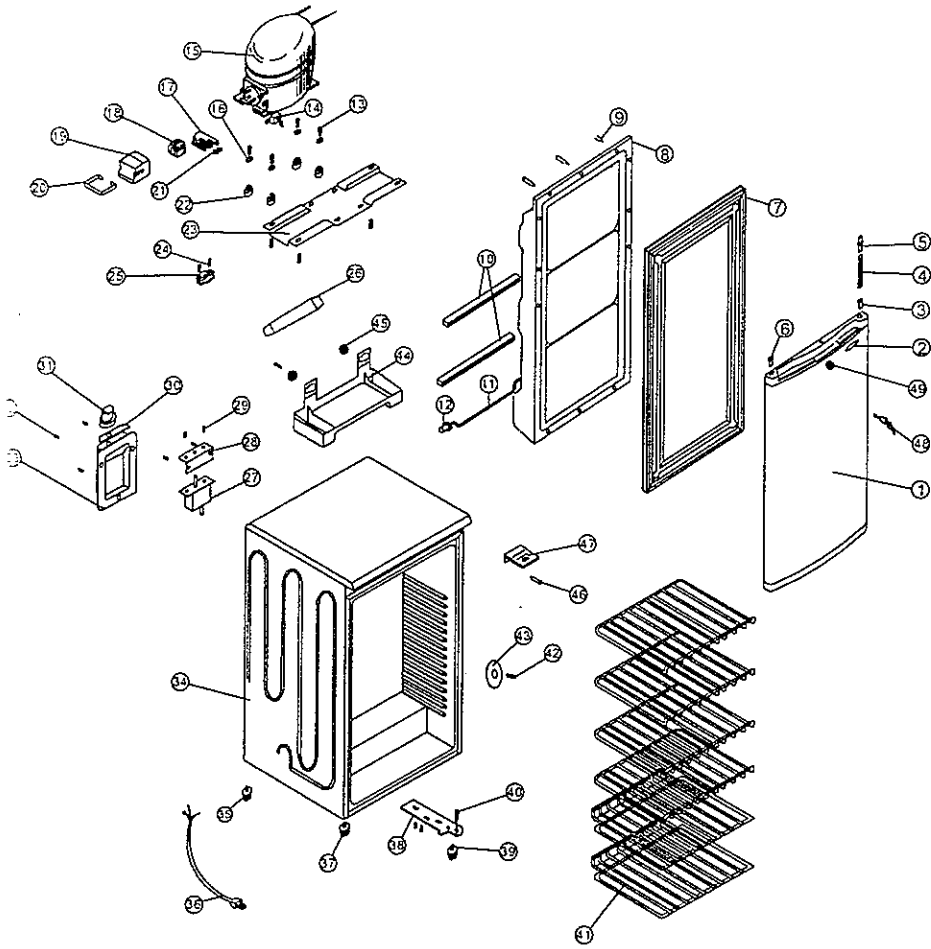

PARTS LIST

ITEM#	DESCRIPTION
1	Door
2	Door Decal
3	Adjustable Casement
4	Spring
5	Door Upper Axis
6	Door Slot Plug
7	Door Gasket
8	Door Liner
9	Shelf Tapping Screw #1
10	Shelf Bar
11	Adjustable Shelf
12	Axis Cover Grommet
13	Compressor Bolt
14	Earth Plate
15	Compressor
16	Compressor Bolt Washer
17	Cord Clamp A
18	PTC relay
19	Protector Relay
20	Relay Cover Retainer
21	Cord Clamp B
22	Rubber Grommet
23	Compressor Base
24	Power Supply Wire Upper Clamp
25	Power Supply Wire Lower Clamp
26	Dryer
27	Thermostat
28	Thermostat Supporter
29	Screw
30	Control Panel
31	Control Knob
32	Screw
33	Thermostat Box
34	Cabinet
35	Base Foot
36	Power Supply Cord
37	Foot
38	Door Lower Hinge
39	Adjustable Door
40	Door Lower Axis
41	Shelf
42	Screw
43	Sensor Cover
44	Drip Tray
45	Clamping Washer
46	Screw
47	Lock Bolt Fix Cover
48	Key
49	Lock Heard

WIRING DIAGRAM

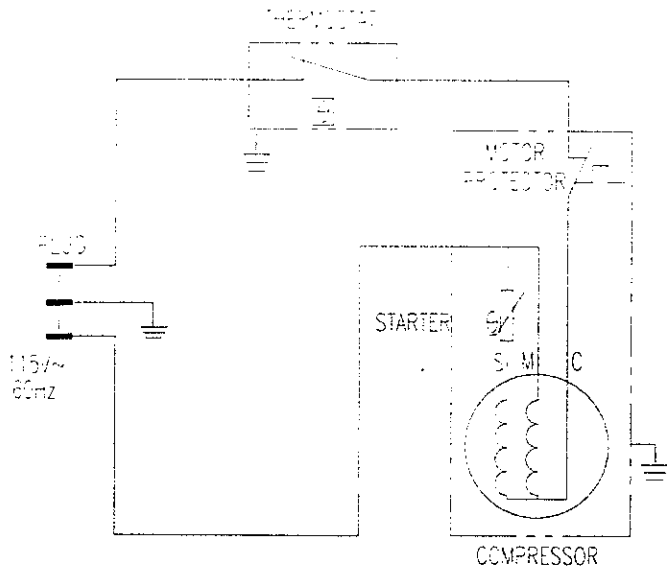

COOLING SYSTEM

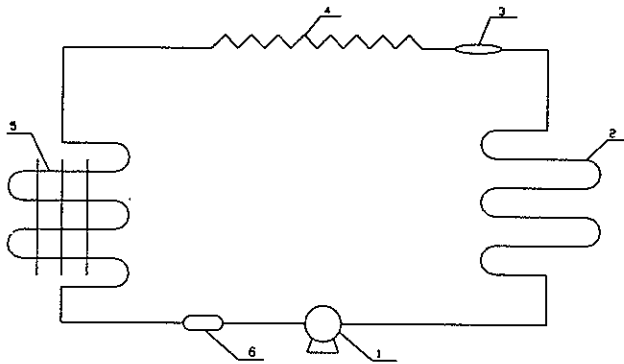

- 1.Compressor 2.Condenser 3.Filter and Drier 4.Capillary
5.Evaporator 6.Accumulator

➤ **INSTALACION**

Retire los accesorios de empaque (plásticos protectores, cartón y tiras engomadas). Limpie el exterior con un trapo suave y seco, y el interior con un trapo húmedo y tibio.

➤ **UBICACION**

1. Seleccione un lugar con un piso firme y nivelado.
2. Su refrigerador requiere ventilación. Deje un espacio mínimo de 5" hacia arriba arriba y espacio suficiente en el respaldo para permitir la circulación de aire
3. Evite luz directa del sol o calor. La luz directa del sol puede afectar la capa de pintura. Las fuentes de calor en su proximidad causarán un consumo mayor de electricidad.
4. Para un mejor desempeño, nivele el refrigerador utilizando las patas ajustables o tornillos niveladores. Para verificar el nivel, abra la puerta hasta la mitad, debe regresar sola.

➤ **INSTRUCCIONES PARA LA CONEXIÓN A TIERRA**

Este aparato electrodoméstico debe estar conectado a tierra. En caso de un cortocircuito eléctrico, la conexión a tierra reduce el riesgo de choque eléctrico proporcionando un cable de escape para la corriente eléctrica. Este aparato viene equipado con un cordón que posee un cable a tierra con un enchufe de conexión a tierra. Este enchufe debe estar conectado en un tomacorriente instalado correctamente y conectado a tierra.

➤ **ADVERTENCIA**

El uso inadecuado del enchufe de conexión a tierra puede resultar en un riesgo de choque eléctrico. Consulte con un electricista si no comprende bien las instrucciones de conexión a tierra o si existe alguna duda sobre si el aparato está conectado a tierra correctamente.

➤ **NO USE UN CORDON DE EXTENSION ELECTRICA**

Use un tomacorriente de pared exclusivo. No conecte su refrigerador a cordones de prolongación eléctrica o junto a cualquier otro electrodoméstico en el mismo tomacorriente de pared.

➤ **ADVERTENCIA IMPORTANTE:**

Un refrigerador vacío es una atracción muy peligrosa para los niños. Quite los sellos magnéticos, puertas o cerraduras de todo electrodoméstico que esté en uso.

➤ **OPERACION**

Enchufe el cable a la toma de corriente, que debe ser 115-120V, 10AMP ó más. Para evitar vibraciones, la caja debe estar bien nivelada. Para encender el refrigerador, gire el control de temperatura a la posición que corresponda al enfriamiento deseado. Bajo condiciones normales mueva el control a la posición "NORMAL".

CUIDADOS EN LOS PERIODOS DE AUSENCIA

Para cortos períodos de ausencia (menos de 21 días) el refrigerador podrá quedar funcionando. Coloque el botón de control de temperaturas en la posición mínima.

En períodos de ausencia más largos, se aconseja dejar el refrigerador limpio y desconectado.

Retire todo lo que tenga adentro del refrigerador y haga la limpieza general.

Deje la puerta entreabierta para que penetre el aire y evitar la formación de olores.

ECONOMIA DE ENERGIA

Evite dejar por mucho tiempo la puerta abierta.

Evite aperturas frecuentes de la puerta.

Nunca coloque alimentos calientes dentro del refrigerador. Espere que estén a una temperatura ambiental.

Coloque el botón de control de temperaturas en la posición adecuada.

SI USTED SE VA DE VACACIONES

Saque todos los artículos del refrigerador si Ud. se va de vacaciones por un mes o más.

Desconecte el refrigerador del tomacorriente y limpie el refrigerador bien.

Deje la puerta abierta para evitar la formación de olores, condensación o moho.

SI USTED SE MUDA

Desconecte el refrigerador del tomacorriente y limpie el refrigerador bien, incluyendo la bandejas del congelador.

Saque todas las partes movibles y empaquételas para que no se muevan durante la transportación.

Cierre la puerta del refrigerador y séllela con cinta adhesiva.

Asegúrese que el refrigerador va parado durante el viaje y cúbralo con una frazada.

➤ REVERSION DE LA PUERTA

- Suelte los 2 tornillos (1) que agarran la bisagra inferior (2) en el lado derecho del gabinete. También destornille la pata (3).
- Suelte la pata (4) y colóquela en el lado derecho.
- Retire la puerta, levantándola despacio y colóquela en una superficie suave para que no se dañe. Asegúrese de soltar el muelle (5) que está localizado dentro del hueco superior derecho de la puerta. También suelte el pin (6) localizado en la parte superior derecha.
- Levante la tapa plástica (7) que cubre el hueco superior izquierdo y tranfiérala al hueco descubierto en el lado derecho. Presione fuertemente hacia abajo la tapa plástica.
- Introduzca el pin superior (6) retirado anteriormente del lado derecho (paso número 3) y colóquelo en el hueco descubierto del lado izquierdo.
- Introduzca el muelle (5) retirado anteriormente (paso número 3) adentro del lado superior izquierdo de la puerta. Encaje la puerta en su nueva posición, asegurándose que el pin (6) entre en la parte de abajo del hueco superior. Aguantando la puerta en la posición derecha asegure la bisagra inferior izquierda (2) retirada anteriormente (paso número 1). Antes de colocar esta bisagra, suelte el tornillo-pin (8) y revierta la dirección de la bisagra.
- Introduzca el tornillo-pin (8) y no lo atornille fuertemente hasta que la parte superior de la puerta este nivelada con la parte superior del congelador.
- Coloque los 2 tornillos (1) retirados anteriormente (paso número 1) y apriételos fuertemente.

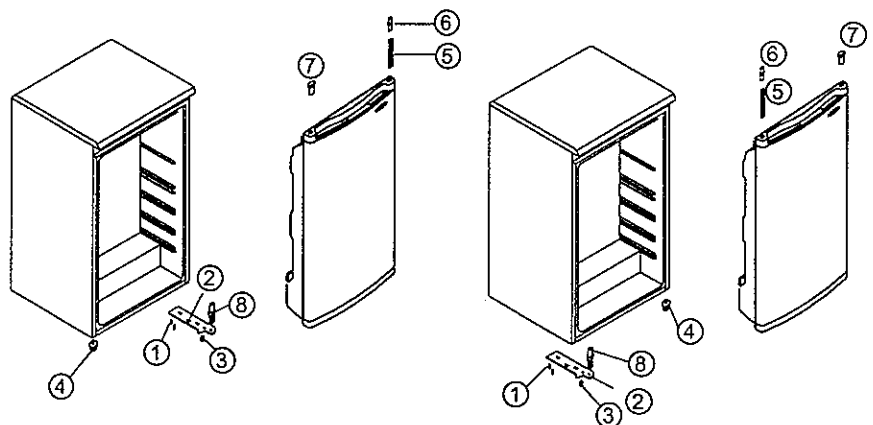

FIGURE 1

FIGURE 2

MANTENIMIENTO Y LIMPIEZA

➤ RECIPIENTE DEL EVAPORADOR

El agua se acumula en el fondo del refrigerador gotea hacia abajo, a través de la ranura en la parte trasera (interior) de la unidad. Esta agua será recogida en el recipiente que se encuentra arriba del compresor, donde se evapora. Para limpiar este recipiente suelte los 2 tornillos que lo agarran al gabinete trasero. Si es necesario extraiga el recipiente, límpielo y vuélvalo a colocar.

IRREGULARIDADES CON EL FUNCIONAMIENTO DEL REFRIGERADOR

PROBLEMA	CAUSAS PROBABLES	SOLUCION
El refrigerador no funciona.	Falta de energía. Tomacorriente defectuoso. Control de temperaturas en la posición "OFF". Enchufe desconectado.	Verifique el fusible. Substitúyalo o arréglo. Coloque el botón en la posición correcta. Conéctelo.
La refrigeración es insuficiente.	Botón de control de temperatura en la posición incorrecta. Elevada frecuencia de apertura de la puerta.	Observe las instrucciones. Evite abrir la puerta demasiado.
Ruidos anormales.	Expansión del gas en el evaporador. Tubos en contacto con gabinetes o paredes	Normal. Aléjelos.