

Avanti[®]

OWNER'S MANUAL

Model Number: HMC5500

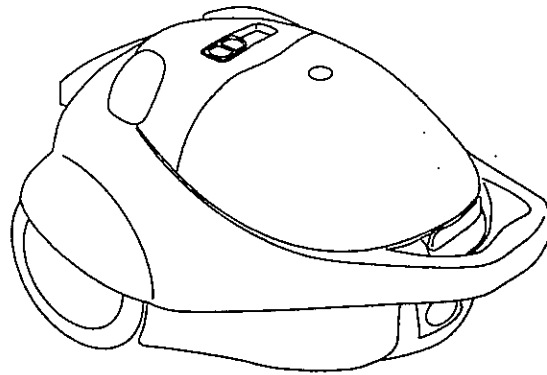

CAUTION:

BEFORE USE, PLEASE READ AND FOLLOW ALL SAFETY RULES AND OPERATING INSTRUCTIONS. THIS VACUUM CLEANER IS INTENDED FOR HOUSEHOLD USE ONLY.

Avanti has a policy of continuous improvement on its products and reserves the right to change materials and specifications without notice.

Avanti Products
P.O. Box 520604 - Miami, Florida 33152
www.avantiproducs.com

Registration Information

Thank you for purchasing this fine Avanti product. Please fill out this card and return it within 100 days of purchase and receive these important benefits:

- > **Protect your product:**
We will keep the model number and date of purchase of your new Avanti product on file to help you refer to this information in the event of an insurance claim such as fire or theft.
- > **Promote better products:**
We value your input. Your responses will help us develop products designed to best meet your future needs.

------(detach here)-----

Avanti Registration Card

Name _____

Model # _____ Serial # _____

Address _____

Date Purchased _____ Store/Dealer Name _____

City _____ State _____ Zip _____

Occupation _____

Area Code _____ Phone Number _____

As Your Primary Residence, Do You:
≤Own _____ ≤Rent _____

Did You Purchase An Additional Warranty:

≤Extended _____ ≤None _____

Your Age:

≤under 18 _____ ≤18-25 _____ ≤26-30 _____
≤31-35 _____ ≤36-50 _____ ≤over 50 _____

Reason For Choosing This Avanti Product:

Please indicate the most important factors that influenced your decision to purchase this product.

≤Price _____
≤Product Features _____

Marital Status:

≤Married _____ ≤Single _____

≤Avanti Reputation _____
≤Product Quality _____
≤Salesperson Recommendation _____
≤Friend/Relative Recommendation _____
≤Warranty _____
≤Other _____

Is This Product Used In The:

≤Home _____ ≤Business _____

How Did You Learn About This Product:

≤Advertising _____ ≤Product Features _____
≤In Store Demo _____ ≤Personal Demo _____
≤Other _____

Comments _____

HELP US HELP YOU...

Read this guide carefully.

It is intended to help you operate and maintain your new vacuum properly.

Keep it handy to answer your questions. If you don't understand something or you need more help, please call:

**Avanti Customer Service
800-220-5570**

Keep proof of original purchase date (such as your sales slip) with this guide to establish the warranty period.

Write down the model and serial numbers.

You'll find them on a label located on the back of the unit.

Please write these numbers here:

Date of Purchase

Model Number

Serial Number

Use these numbers in any correspondence or service calls concerning your vacuum.

If you received a damaged vacuum, immediately contact the dealer that sold you the vacuum.

IF YOU NEED SERVICE

We're proud of our service and want you to be pleased. If for some reason you are not happy with the service you receive, here are some steps to follow for further help.

FIRST, contact the store that sold and/or serviced your vacuum. Explain why you are not pleased. In most cases, this will solve the problem.

NEXT, if you are still not pleased, write all the details, including your telephone number, and send to:

**Customer Service
Avanti Products
10880 NW 30 Street
Miami, FL 33172**

Table Of Contents

| | |
|-----------------------------------|----|
| Registration Information | 2 |
| Help Us Help You | 3 |
| Parts And Features | 5 |
| Important Safety Instructions | 6 |
| Assembling Your Vacuum | 7 |
| Storing Your Vacuum | 8 |
| Using And Replacing Your Dust Bag | 8 |
| Changing Your Filter | 9 |
| Cleaning Your Vacuum | 9 |
| Service For Your Vacuum | 9 |
| Warranty Information | 10 |

PARTS AND FEATURES

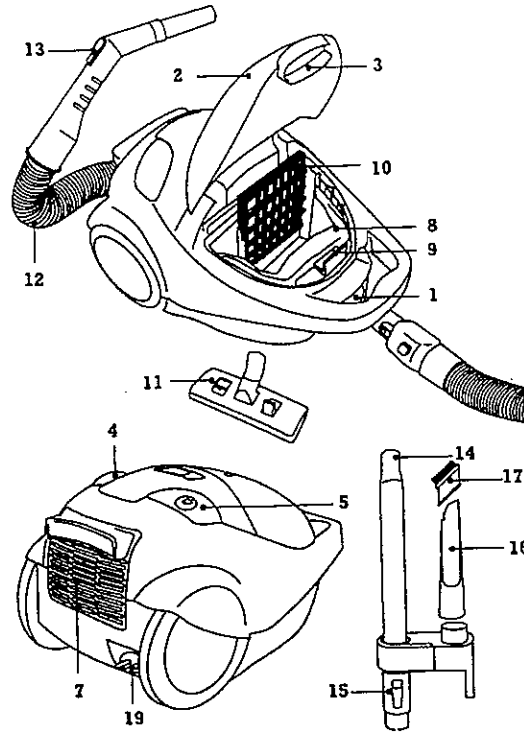

- | | |
|-----------------------------|------------------------------|
| 1. Suction Nozzle | 11. Floor Brush |
| 2. Cover | 12. Flexible Hose |
| 3. Cover Opening Catch | 13. Manual Air Control |
| 4. On/Off Switch | 14. Extension Tube |
| 5. Rewind Switch | 15. Telescopic Tube Coupling |
| 6. Variable Power Control | 16. Crevice Nozzle |
| 7. Air Outlet Grill/Filter | 17. Nozzle Brush |
| 8. Dust Bag | 18. Dust Bag Full Indicator |
| 9. Dust Bag Holder | 19. Cord |
| 10. Motor Protection Filter | |

Important Safety Instructions

| | |
|--|---|
| WARNING | To reduce the risk of fire, electrical shock, or injury when using your vacuum cleaner, follow these basic precautions: |
| <ul style="list-style-type: none">• Read all instructions before using the vacuum.• Electric shock could occur if used outdoors or on wet surfaces.• Keep children away from the vacuum cleaner at all times. Injury could result from suction and moving parts.• Never leave a vacuum cleaner plugged in and unattended near children.• Never put hands, feet or hair near the rotating brush or hose end of an operating vacuum cleaner. Personal injury could result.• The cord moves rapidly when rewinding. Keep children away, provide a clear path and hold plug when rewinding the cord to avoid personal injury.• Never vacuum cigarette butts or fireplace ashes.• Never use vacuum cleaner where flammable vapors from cleaning fluids, perfumes, etc. are present. This could start a fire.• Never use the vacuum to pick up sharp hard objects, small toys, pins, paper, etc. They may damage the vacuum cleaner or dust bag.• Keep vacuum cleaner on the floor- not on chairs, tables, etc.• Use caution when cleaning stairs.• Never place sharp or heavy objects on power cord. Possible shock or fire hazard could occur.• Use only recommended parts and attachments.• Never run the vacuum cleaner over other power cords. Possible shock or fire hazard could occur.• Never operate with a damaged cord or plug.• Always turn off cleaner before removing or replacing any parts from the vacuum cleaner.• Always change the dust bag after vacuuming carpet cleaners or fresheners, powders and fine dust. These products clog the bag, reduce airflow and can cause the bag to burst.• Always unplug the power cord by pulling the plug, not the cord.• Always turn off the vacuum cleaner before unplugging it.• Always unplug your vacuum cleaner whenever you leave it for more than a moment or when not in use.• Never operate with a punctured hose. Replace if cut or worn. <p style="text-align: center;">-SAVE THESE INSTRUCTIONS-</p> | |

➤ Assembling Your Vacuum

Insert the flexible hose in the suction inlet by matching the flange with flexible hose slot until it is fixed tight. To release it, press down on the button of the flexible hose and pull upwards.

To extend the extension wands to the length you require, attach the wands together then fit the brush or nozzles in it and insert the flexible hose at the other end of the extension wand.

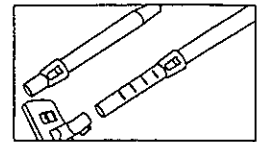
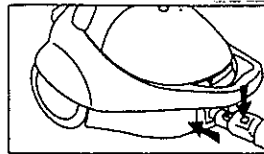

Pull out the power cord and plug it into the electric outlet.

Note: The end of the cord is indicated by a yellow mark. Do not pull the cord when this mark is visible as this could cause irreparable damage to the cord rewind.

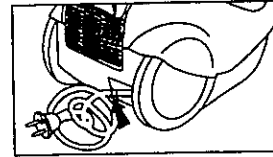

Press down on the On/Off pedal to start the vacuum cleaner. When you want to stop, press down on the pedal again.

Before starting the vacuum cleaner, adjust the power to the minimum and afterwards select the power you require.

With the electronic power control you can adjust the suction power for the floor type, to any point from the minimum position, which should be used for curtains and delicate fabrics, to the maximum position, for intense dirt and hard floors.

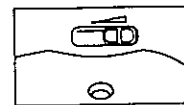

The suction force can be regulated manually from the handle.

Aperture shut: greatest suction force

Aperture open: least suction force.

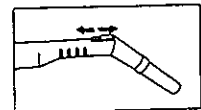

The floor brush has two working positions, depending on the floor type:

- a) Position for hard floors
- b) Position for carpets and mats

When you have finished using the vacuum cleaner, stop it, unplug it and press down on the automatic cord rewind pedal. Make sure that the cord rolls up with no twists, by guiding it with your hand if necessary.

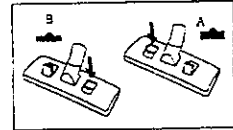

➤ Storing Your Vacuum

The appliance may be stored vertically, inserting the telescopic tube-coupling hood into the housing next to the suction inlet. You can store the nozzles in the telescopic tube coupling.

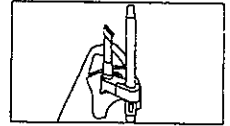

➤ Using And Replacing Your Dust Bag

When the indicator turns red, the dust bag needs to be changed.

Note: If after inserting a new dust bag, the indicator stays red, this could be for one of the following reasons:

- ❖ Suction passages are obstructed
Flexible and extension wands, suction inlet, floor brushes and nozzles
- ❖ Motor suction filter dirty
- ❖ Air outlet filter dirty



Check carefully, which of these is causing the indicator to stay red and correct it so that the vacuum cleaner can work normally. If you cannot locate the cause, bring the appliance to the nearest after-sales service. Do not work with the vacuum cleaner when the indicator is red, for this could cause irreparable damage to the motor.

Changing The Dust Bag

- 1) Unplug the vacuum, remove the flexible hose from the suction inlet and open the cover by pressing on the opening catch.
- 2) Release the bag from the bag holder, hold it by its cardboard edge and dispose of it without compressing it.
- 3) Fit a new bag in the bag holder by setting the cardboard edge in its housing, so that the mouth of the bag is concentric in the opening of suction inlet.

- 4) The appliance has a safety device, which stops the lid from closing if the bag is not fitted.

Do not reuse a used bag since the dust block the bag's pores and impairs the performance of the vacuum. Change the dust bag whenever the indicator is red or you note that the suction power has reduced significantly. Note: Do not use the vacuum cleaner without the dust bag because this can damage the motor.

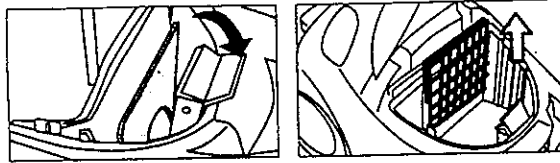

➤ Changing Your Filter

Unplug the vacuum cleaner.

Motor Protection Filter

This filter is located in the dust bag compartment and protects the motor from dust. To take it out, pull the grille which holds it upwards and replace it with a new one for every 5 dust bag changes.

Note: Do not use the vacuum cleaner without the motor protection filter.

Air Outlet Filter

Filters the air which is expelled. To change it, remove the grille which holds it and replace it after every 5 dust bag changes.



➤ Cleaning Your Vacuum

Before carrying out any cleaning operation, unplug the vacuum cleaner. The vacuum and its tools can be cleaned with a damp cloth. Do not use solvents or abrasive products to clean it. **DO NOT PUT THE VACUUM CLEANER IN WATER OR ANY OTHER LIQUID.**

SERVICE FOR YOUR VACUUM

We are proud of our customer service organization and the network of professional service technicians that provide service on your Avanti appliances. With the purchase of your Avanti vacuum, you can have the confidence that if you ever need additional information or assistance, the Avanti Products Customer Service team will be here for you. Just call us toll-free.

AVANTI PRODUCTS CUSTOMER SERVICES

| | |
|-------------------------------------|--|
| Product Information 800-323-5029 | Whatever your questions are about our products, help is available. |
| Part Orders 800-220-5570 | You may order parts and accessories that will be delivered directly to your home. You may order these items by personal check, money order, Master Card, or Visa. |

| | |
|--------------------------------------|--|
| YOUR Avanti Products WARRANTY | Staple your sales receipt here. Proof of original purchase date is needed to obtain service under warranty. |
|--------------------------------------|--|

WHAT IS COVERED

LIMITED ONE-YEAR WARRANTY

For one year from the date of purchase by the original owner, Avanti Products will, at its option, repair or replace any part of the appliance, which proves to be defective in material or workmanship under normal use. During this period, Avanti Products will provide all parts necessary to correct any such defect free of charge, as long as the appliance has been operated in accordance with the written instructions in this manual. In rental or commercial use, the warranty period is 90 days. All Home Maker Vacuums must be brought/sent to an authorized service center for repair. This warranty does not apply outside the Continental USA.

WHAT TO DO IF YOU HAVE PROBLEMS: Should your Home Maker Vacuum product prove defective during the warranty period, please return to the authorized dealer where the vacuum was purchased. Avanti Products will, at its option, replace on an exchange basis the defective part(s), without any charge.

WHAT IS NOT COVERED

This warranty covers only normal consumer use. This warranty does not cover bags, belts, lamps, agitator brush, roller brushes, motor carbon brushes, filters and any third party parts, components or other parts added to the Home Maker Vacuum after its shipment from Avanti to its dealers. Avanti is not responsible for warranty service should the Home Maker Vacuum label or logo or the rating label or serial number be removed or should the product fail to be properly maintained or fail to function properly as a result of misuse, abuse, improper operation, neglect, improper shipping, damage caused by disasters such as fire, flood, and lightning, improper electrical current, commercial use, or service other than by an Avanti Products Authorized Servicer. Packaging and shipping cost incurred in presenting your Home Maker Vacuum product for warranty service are your responsibility. If a claimed defect cannot be identified or reproduced in service, you will be held responsible for costs incurred.

THE WARRANTY PROVIDED ABOVE IS EXCLUSIVE AND IN LIEU OF ALL OTHER EXPRESS OR IMPLIED WARRANTIES INCLUDING, BUT NOT LIMITED TO THE IMPLIED WARRANTIES OF MERCHANTABILITY OR FITNESS FOR A PARTICULAR PURPOSE. SOME LAWS DO NOT ALLOW THE EXCLUSION OF IMPLIED WARRANTIES. IF THESE LAWS APPLY, THEN ALL EXPRESS AND IMPLIED WARRANTIES ARE LIMITED TO THE WARRANTY PERIOD IDENTIFIED ABOVE. UNLESS STATED HEREIN, ANY STATEMENTS OR REPRESENTATIONS MADE BY ANY OTHER PERSON OR FIRM ARE VOID. EXCEPT AS PROVIDED IN THIS WRITTEN WARRANTY, NEITHER AVANTI PRODUCTS, NOR ITS AFFILIATES SHALL BE LIABLE FOR ANY LOSS, INCONVENIENCE OR DAMAGE INCLUDING DIRECT, SPECIAL, INCIDENTAL OR CONSEQUENTIAL DAMAGES, RESULTING FROM THE USE OR INABILITY TO USE THE HOME MAKER VACUUM PRODUCT, WHETHER RESULTING FROM BREACH OF WARRANTY OR ANY OTHER LEGAL THEORY.

Some jurisdictions do not allow limitations on how long an implied warranty lasts and some jurisdictions do not allow the exclusion or limitation of incidental or consequential damages, so the above limitations and exclusions may not apply to you. This warranty gives you specific legal rights, and you may also have other rights, which vary from jurisdiction to jurisdiction.

Printed in China